

Dowel Pin

Material: Stainless Steel

Class Grade: A4-70 G316

Corrosion Protection Level: Ultimate

Standard: DIN 7

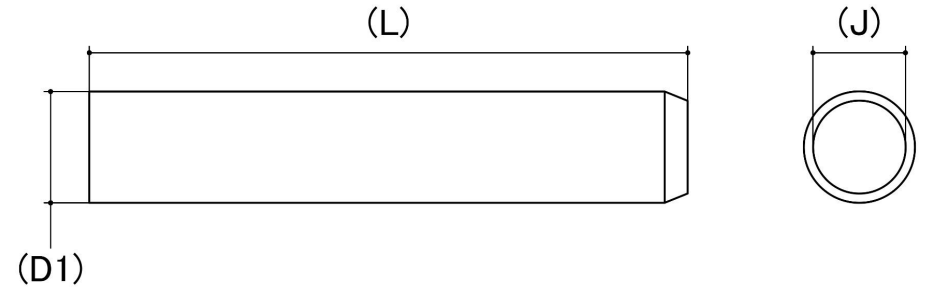

*Cad Drawings shown for graphic representation only.**

Size	Dowel Pin Diameter (D) (mm)		Point Diameter (J) (mm)		Crown Height (mm)	Length Round End Chamfer (mm)	sku (Part Number)
	Min	Max	Min	Max	Nom	Nom	
M2	2.00	2.01	1.60	1.90	0.60	0.18	37DPS2M
M2.5	2.50	2.51	2.10	2.40	0.70	0.25	37DPS25M
M3	3.00	3.01	2.60	2.90	0.80	0.30	37DPS3M
M4	4.00	4.01	3.60	3.90	0.90	0.40	37DPS4M
M5	5.00	5.01	4.60	4.90	1.00	0.50	37DPS5M
M6	6.00	6.01	5.40	5.80	1.10	0.60	37DPS6M

Disclaimer:

Dimensional data and technical information was obtained from publically available sources and not acquired through standard agencies. It has been completed and compiled for reference purposes only; where discrepancies are found they are subject to change without notice. Bolt & Nut Australia makes no warranties or representations regarding the accuracy and validity of the compiled information and data. Contact the relevant standard authorities for accurate and detailed information.

* Cad Drawings may not reflect diameter, thread length or overall length.

© Bolt & Nut Australia Pty Ltd. All rights reserved.

Version: 02 May 2025